

REV. NUMBER	DATE	BY	APPROVED
1	11/15/01	MAN	11/15/01

REVISIONS

DESCRIPTION

ORIGINAL RELEASE

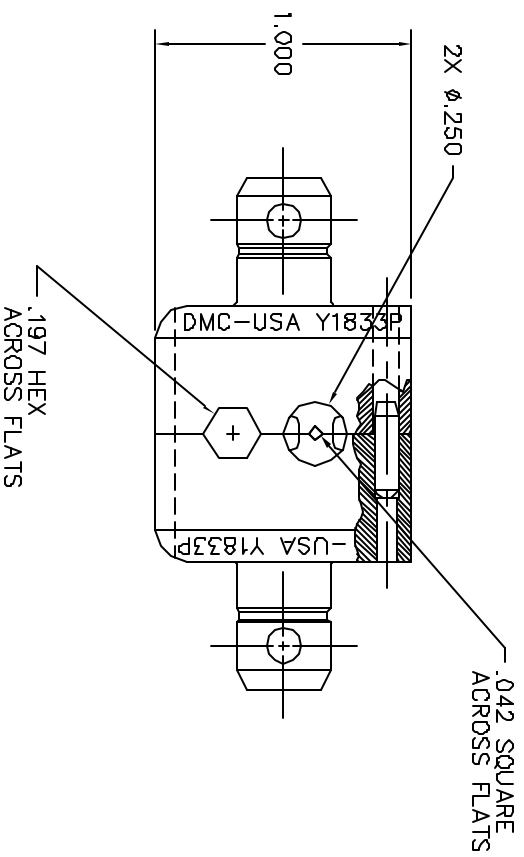
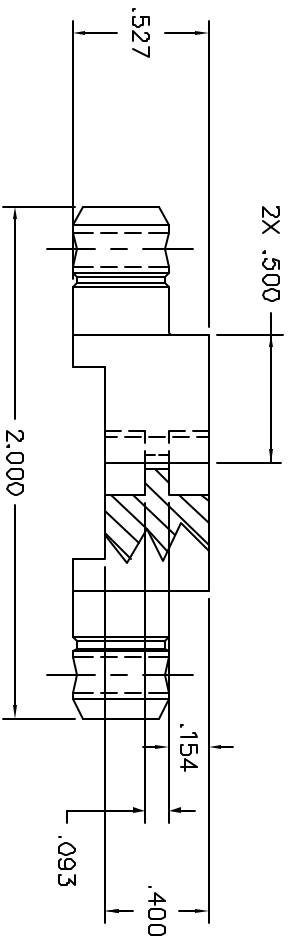

**UNCONTROLLED DOCUMENT  
WILL NOT BE UPDATED**

1. FOR ADC #LCC-111012.  
NOTES:

RESTRICTED & CONFIDENTIAL  
CONTENTIAL PROPERTY OF DANIELS  
MANUFACTURING CORP. NOT TO BE  
REPRODUCED OR USED FOR ANY OTHER  
PURPOSE, EXCEPT AS AUTHORIZED IN WRITING  
BY DANIELS MANUFACTURING.  
MUST BE RETURNED TO DANIELS  
MANUFACTURING CORP. ON COMPLETION  
OF ORDER OR AS OTHERWISE FOR  
MATERIAL.

DO NOT SCALE DRAWING

MATERIAL	ITEM	PART NO.	QTY.	DESCRIPTION/REMARKS
HEAT TREAT	DRW CHK'D APPR'D	J. JOYCE RRR	DATE DATE DATE	DATE DATE DATE
FINISH	TITLE DIE SET ENVELOPE DRAWING			
WHERE USED:				
SIZE B	SCALE 2X	DWG P/N Y1833P-ENV	SHEET 1	OF 1
			REV	1

**DMC** DANIELS MANUFACTURING CORP.  
ORLANDO, FLORIDA  
CASE 11851