

REVISIONS				
REV. SYM.	E.C.O. NUMBER	DESCRIPTION	BY DATE	APP'D DATE
2		REDRAWN	AAM 1-22-01	RRR 1-22-01

**UNCONTROLLED DOCUMENT  
WILL NOT BE UPDATED**

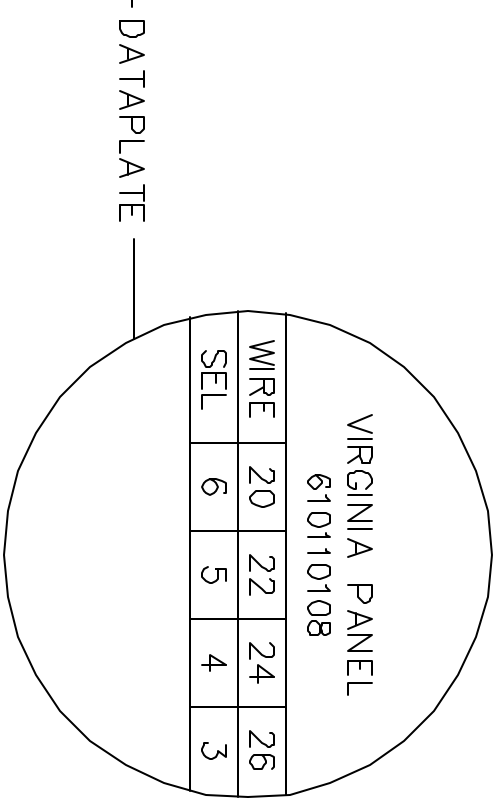
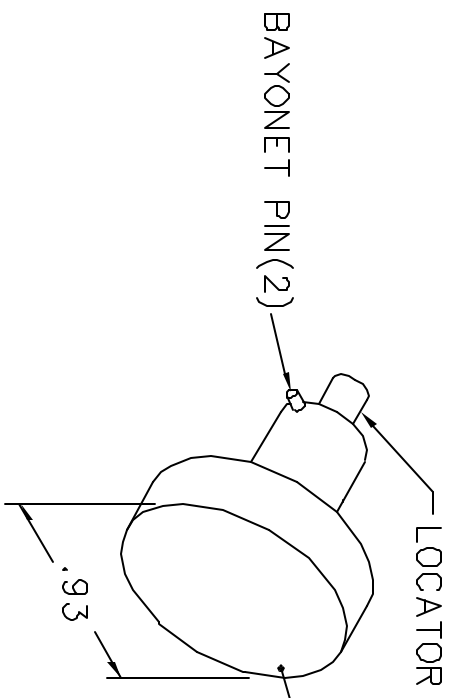
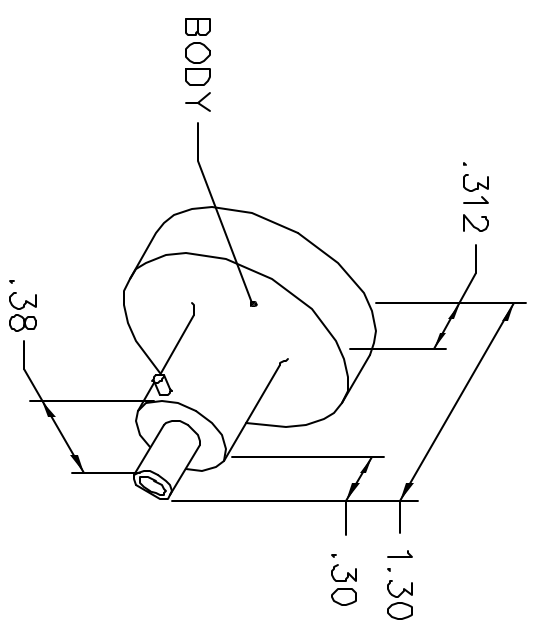

NOTE: FOR USE WITH DANIELS CRIMP TOOLS ACCOMMODATING "K" SERIES POSITIONERS

LOCATOR	ADDITIONAL FEATURES
HOLE DIMENSIONS	∅.055
	∇.889
	┌└∅.125
	∇.69

**RESTRICTED & CONFIDENTIAL**

CONFIDENTIAL PROPERTY OF DANIELS MANUFACTURING CORP. NOT TO BE DISCLOSED TO OTHERS, REPRODUCED OR USED FOR ANY OTHER PURPOSE, EXCEPT AS AUTHORIZED IN WRITING BY DANIELS MANUFACTURING. MUST BE RETURNED TO DANIELS MANUFACTURING CORP. ON COMPLETION OF ORDER OR OTHER PURPOSE FOR WHICH LENT.

DO NOT SCALE DRAWING

DRN. MC	DATE	6-28-93
CHK'D. RRR	DATE	6-28-93
APP'D.	DATE	
APP'D.	DATE	
<p>NOTE: THIS DRAWING IS AN OUTLINE DRAWING OF THE RESPECTIVE DMC PART NUMBER INDICATED. ACTUAL DMC PART NUMBER IS DRAWING NUMBER WITHOUT THE "-ENV" SUFFIX.</p>		
TITLE		ENVELOPE DRAWING POSITIONER
WHERE USED: AFMB		
SIZE	SCALE	CAD P/N
A	NTS	K972-ENV
POSTING	DWG. NO.	K972-ENV
	SHEET	OF
	1	1
	REV.	2



DANIELS MANUFACTURING CORP.  
ORLANDO, FLORIDA  
CAGE 11851