

REVISIONS				
REV. SYM.	E.C.O. NUMBER	DESCRIPTION	BY DATE	APP'D. DATE
1		ORIGINAL RELEASE	DUNG CAO 6-12-95	DE 6-95

**UNCONTROLLED DOCUMENT  
WILL NOT BE UPDATED**

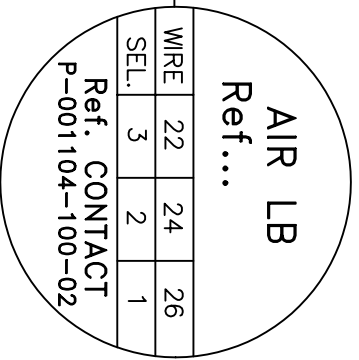
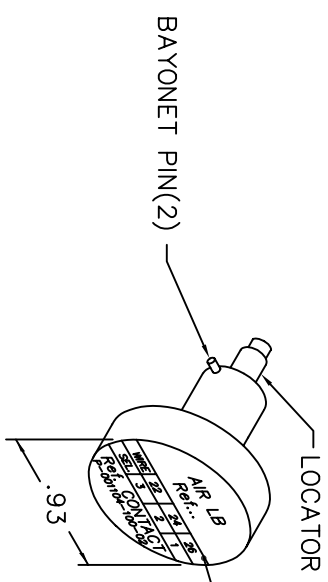
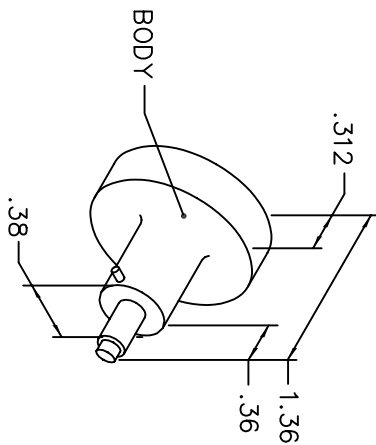

HOLE DIA.	ADDITIONAL FEATURES
∅.052	└┘ ∅.062
└┘ .430	└┘ .100

RESTRICTED & CONFIDENTIAL		MATERIAL		ITEM		PART NO.		QTY.		DESCRIPTION/REMARKS	
CONFIDENTIAL PROPERTY OF DANIELS MANUFACTURING CORP. NOT TO BE DISCLOSED TO OTHERS, REPRODUCED OR USED FOR ANY OTHER PURPOSE, EXCEPT AS AUTHORIZED IN WRITING BY DANIELS MANUFACTURING. MUST BE RETURNED TO DANIELS MANUFACTURING CORP. ON COMPLETION OF ORDER OR OTHER PURPOSE FOR WHICH SENT.		HEAT TREAT FINISH		DBN. DUNG CAO DATE 6-12-95		DATE 6-12-95		DTG DATE 6-95		DANIELS MANUFACTURING CORP. ORLANDO, FLORIDA CAGE 11851	
				APP'D. DATE		DATE		DATE		TITLE POSITIONER ENVELOPE DRAWING	
DO NOT SCALE DRAWING				NOTE: THIS DRAWING IS AN OUTLINE DRAWING OF THE RESPECTIVE DMC PART NUMBER INDICATED. ACTUAL DMC PART NUMBER IS DRAWING NUMBER WITHOUT THE "-ENV" SUFFIX.		WHERE USED: SIZE B SCALE NTS POSTING		SHEET OF 1 REV. 1			

NOTE: FOR USE WITH DANIELS CRIMP TOOLS  
ACCOMMODATING "K" SERIES POSITIONERS