

REVISIONS				
REV. NUMBER	E.C.D. NUMBER	DESCRIPTION	BY DATE	APP'D DATE
1		ORIGINAL RELEASE	RRR 10/14/83	RRR 10/8/83

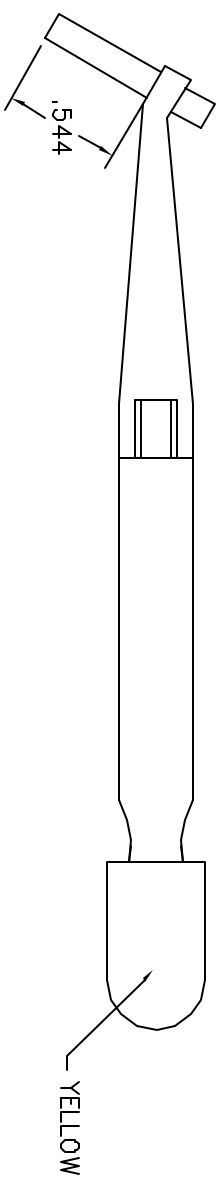
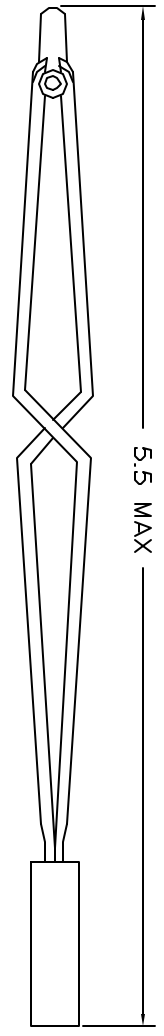
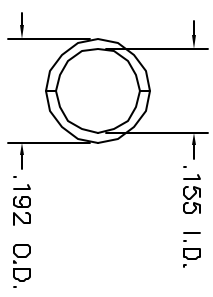
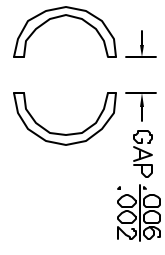

**UNCONTROLLED DOCUMENT  
WILL NOT BE UPDATED**

RESTRICTED & CONFIDENTIAL		CONFIDENTIAL PROPERTY OF DANIELS MANUFACTURING CORP. NOT TO BE DISCLOSED TO OTHERS, REPRODUCED OR USED FOR ANY OTHER PURPOSE, EXCEPT AS AUTHORIZED IN WRITING. MAY BE REPRODUCED TO DANIELS MANUFACTURING CORP. ON COMPLETION OF ORDER OR OTHER PURPOSE FOR WHICH INTD.	
MATERIAL	FINISH	HEAT TREAT	DO NOT SCALE DRAWING
ITEM	PART NO.	QTY.	DESCRIPTION/REMARKS
DRAWING NO. MGS	DATE 10/4/83		DANIELS MANUFACTURING CORP. ORLANDO, FLORIDA CAGE 71857
CHKD. TR	DATE 10/5/83		
APPRO. RS	DATE 10/8/83		INSERTION TOOL # 12 ENVELOPE DRAWING (MS27495A12)
NOTE: THIS DRAWING IS AN OUTLINE DRAWING. THE ACTUAL DIMENSIONS INDICATED IN THIS DRAWING MAY VARY FROM THE DIMENSIONS OF THE PART NUMBER IS DRAWING WITHOUT THE "ENV" SUFFIX.		WHERE USED:	CAD P/N DAK95-12-ENV SHEET 1 OF 1
		POSTING	DWG. NO. DAK95-12-ENV REV. 1