

REV.	DATE	BY	APP'D
1	9/20/99	9/20/99	9/20/99

REV.	DATE	DESCRIPTION
1	9/20/99	ORIGINAL RELEASE

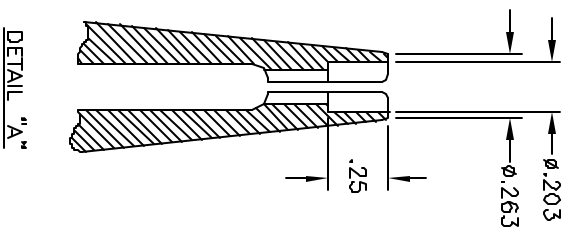
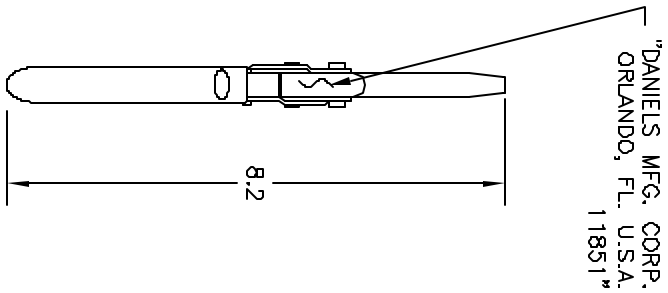
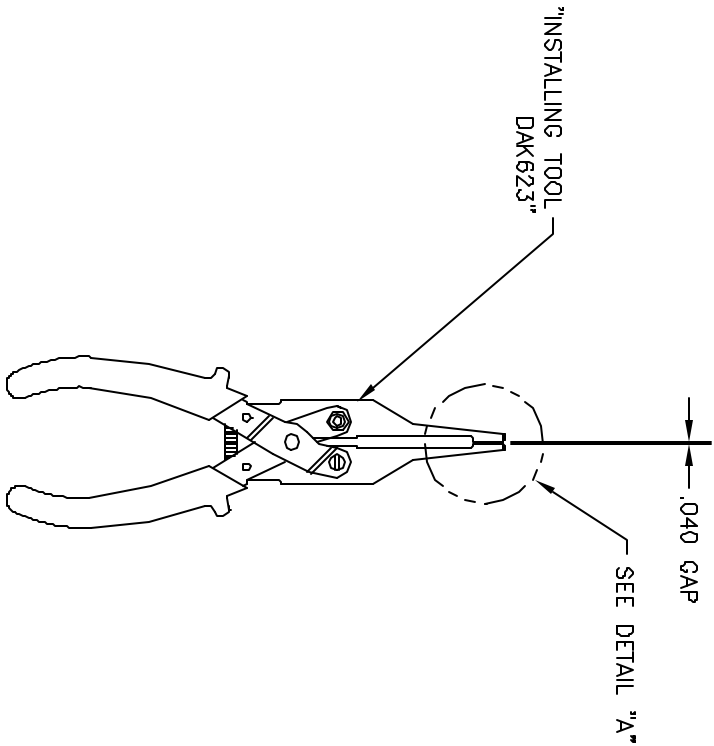

**UNCONTROLLED DOCUMENT  
WILL NOT BE UPDATED**

RESTRICTED & CONFIDENTIAL		MATERIAL		ITEM		PART NO.		QTY.		DESCRIPTION/REMARKS	
CONFIDENTIAL PROPERTY OF DANIELS MANUFACTURING CORP. NOT TO BE REPRODUCED OR USED IN ANY MANNER EXCEPT AS AUTHORIZED IN WRITING BY DANIELS MANUFACTURING. MUST BE RETURNED TO DANIELS MANUFACTURING CORP. IN COMPLETE CONDITION OF ORDER WHICH IDENT.		HEAT TREAT		DRIN. J. JOYCE	DATE 9/20/99	RRR					DANIELS MANUFACTURING CORP. ORLANDO, FLORIDA CASE 11851
		FINISH		APPL'D	DATE						INSTALLING TOOL ENVELOPE DRAWING
DO NOT SCALE DRAWING				WHERE USED:		SIZE		SCALE		SHEET OF	
				P/N		DAK623-ENV		1		1	
				P/N		DAK623-ENV		1		1	